

Fixed Focal (8mm)

YF8A-2

Applicable camera (model) 1 2/3 1/2 1/3 1/4 For Security

Fixed Focal	Manual Iris	CS Mount	Large Aperture Ratio	RoHS Compliant
FIXED	MANUAL	CS-mt	F1.2	RoHS



* Photograph is a similar model.

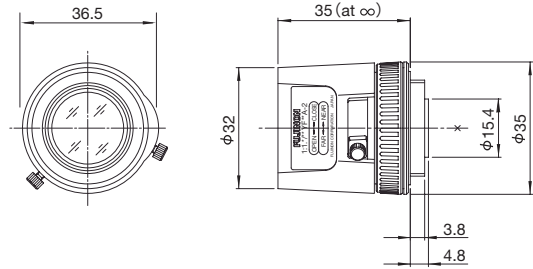

Unit : mm

YF8A-2

Focal Length (mm)		8
Iris Range		F1.2 - Close
Operation	Focus	Manual
	Iris	Manual
Angle Of View (H×V)	1/3"	33°24' × 25°22'
	1/4"	25°22' × 19°09'
Focusing Range (From Front Of The Lens)(m)		∞ - 0.1
Object Dimensions at M.O.D. (H×V)(mm)	1/3"	71 × 53
	1/4"	53 × 40
Back Focal Distance (in air) (mm)		8.81
Exit Pupil Position (From Image Plane) (mm)		-147
Filter Thread (mm)		-
Mount		CS
Mass (g)		30
Coil Resistance		-
Current Consumption		-
Remarks		