

FDR AcSelerate

The new pinnacle in diagnostic imaging from Fujifilm

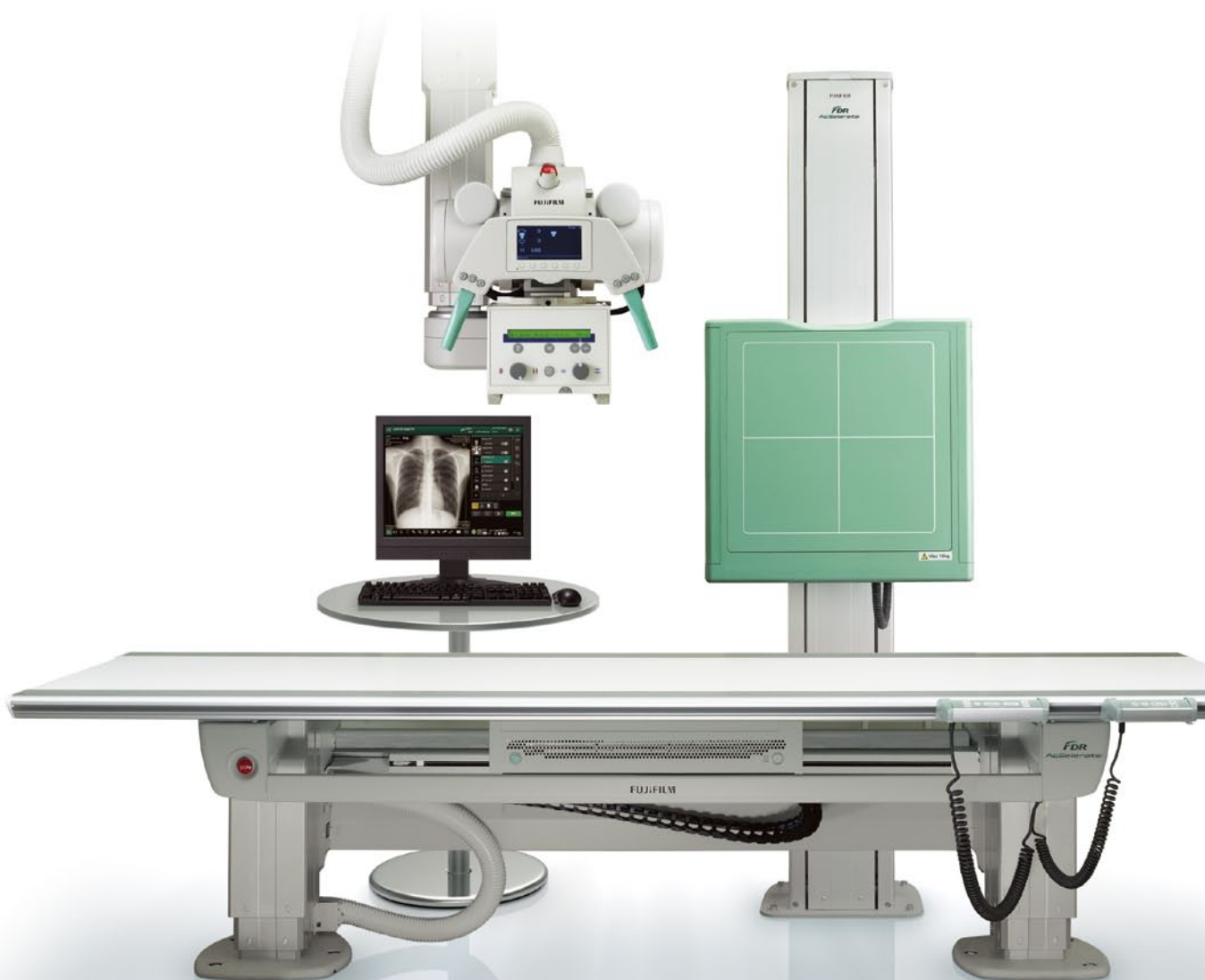

AcSelerate has been ergonomically designed, not only for the technologist, but also for the patient.

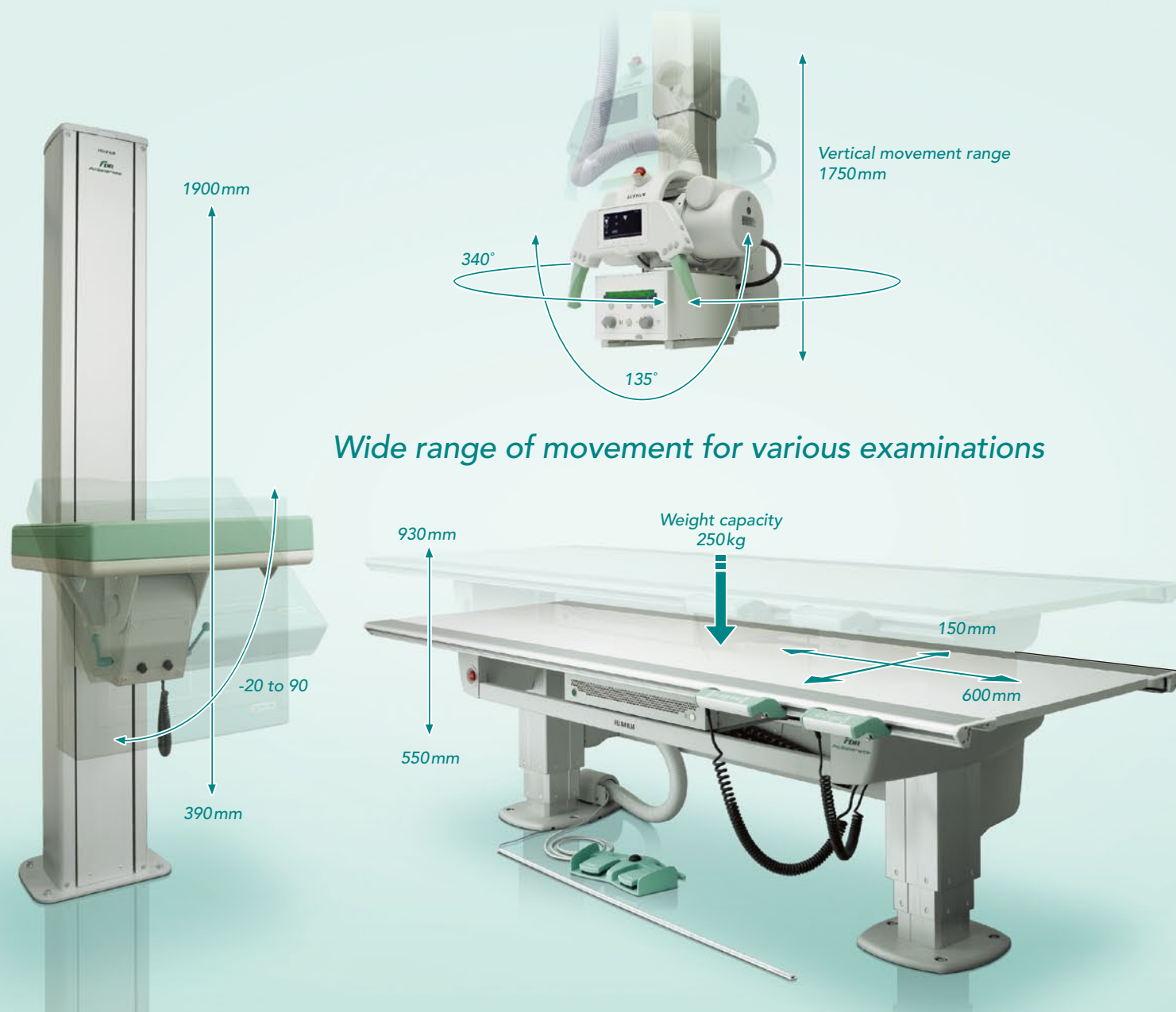

Light-weight Ceiling Suspension System

The lightweight ceiling suspension system and tube head provide smooth movement to any position, to any angle and to any height within the examination room. The support features an extended range of vertical movement, 1750 mm, which allows for easy examination of the lower extremities.

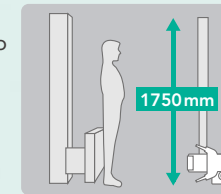

Tilting Upright Stand

The vertical movement of the flat panel detector can be operated either using the motor or manually from a height of 390 mm from the floor to 1900 mm. The motorized vertical movement allows you to improve your workflow when taking a variety of exposures not only of the chest and abdomen but also exposures from the cervical spine down to the lower extremities. In addition, with the minus 20 degrees to 90 degrees angulation capability, the skull and upper extremities can also be examined as with the exposures of the elbow.



Table

The table size is 2400 mm x 850 mm with an adjustable height of 550 mm to 930 mm from the floor, and weight capacity is 250 kg, making it extremely flexible for easy positioning and for accommodating all types and sizes of patients. The floating top table is equipped with three control methods depending upon operational need. Tomography is available as a standard feature.



Generator

Ease of use in connection with CONSOLE ADVANCE



Intuitive and flexible for any type of exams, the Generator can perform a wide range of studies on patients of all sizes from babies to adults. It also features CONSOLE ADVANCE, an easy-to-view display, which enables you to set the exposure settings easily and to start up and shut down the system quickly.

Optional accessories



Increase efficiency with automated functionality

Auto-Positioning

By selecting the program from the exposure menu, on the CONSOLE ADVANCE, the X-ray tube automatically moves to the required position using the 5-axis motorized tube support. Manual adjustments can always be applied, however, the simplicity and accuracy of AcSelerate make manual movements a thing of the past!

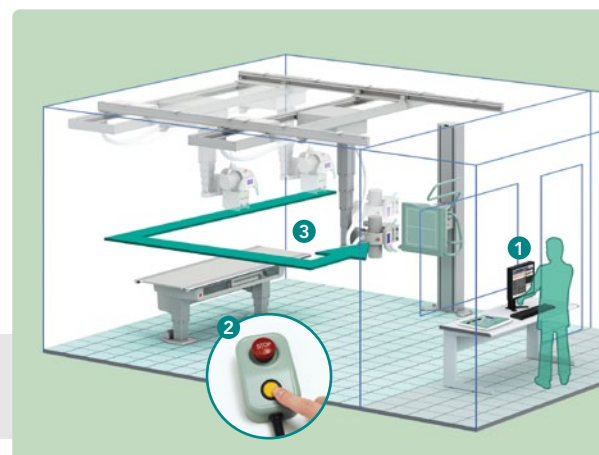

- 1 Select from exposure menu
- 2 Activate X-ray tube with remote controller
- 3 X-ray tube automatically positions

Auto-Tracking

When the patient is on the table, the FPD will auto-track the manual movement of the X-ray tube to allow examination of the intended body part. If the patient is at the upright detector, the X-ray tube will automatically track the vertical movements of the FPD.

- Manual operation
- Auto-Tracking

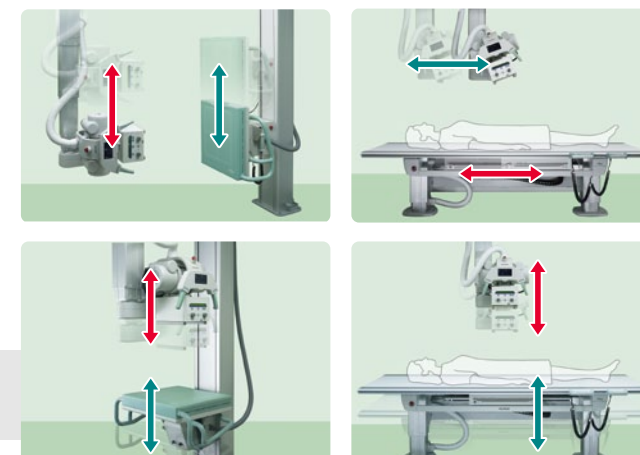

Auto-Collimation

The required collimation area, taking into account the SID (Source to Image Distance) is automatically adjusted to the body part selected from the exposure menu. Manual adjustments can be made easily if needed.

Auto-Filtering

Three sizes of copper filter automatically adjust to the designated body part selected on the exposure menu thus reducing unnecessary radiation, this filtration can also be used manually.

FDR AcSelerate Specifications

X-ray system

- Line voltage connection: 400V 3~(3N~), 480V 3~±10% (50Hz/60Hz)
- Power consumption: 110kVA

Ceiling Tube support

- Fully motorized 5 axes ceiling tube support
- Vertical travel range: 175cm
- Minimum focus-ceiling distance: 89cm
- Tube rotation alpha/beta: alpha: 135 degree beta: 340 degree
- Tomography application
- Automatic positioning

Generator

- High frequency generator
- Output: 65kW / 80kW*1
- Exposure voltage: 40 to 150kVp
- mA range: 10 to 800mA [10 to 1000mA]
- AEC (upright stand/table): 3 fields ion-chamber
- DAP*2 (inside collimation)

X-Ray Tube

- Focal spot: 0.6/1.2mm [0.6/1.0mm]*1
- Anode heat storage capacity: 400kHU [600kHU]
- Anode heat dissipation rate: Max 125kHU/min.
- Output of the small/large focus: 40/100kW [32/72kW]

Collimator

- Copper filter: 0.1mm, 0.2mm, 0.3mm
- Rotation: 45 degree
- Square collimation: Manual / Motorized

Table

- Tabletop size: 850 X 2400mm
- Table height: 550 to 930mm
- Travel range: transverse: 150mm longitudinal: 600mm
- Detector travel range: ≤630mm
- Max. table load: 250kg
- Automatics synchronization function
- Accessories: Hand control (table operation and collimation control)
 - Patient hand grips
 - Lateral cassette holder*2
 - X, Y and Z foot control vertical movement*2
 - X and Y foot control strip type*2
 - Compression belt*2
 - Tabletop mattress*2
 - Grid*2

Upright stand

- Travel range (central beam - floor): Motorized 390 to 1900mm
- Tilting angle: -20 to 90 degree
- Automatic synchronization function
- Accessories: Hand control (collimation & detector elevation control)
 - Foot switch for manual
 - Patient grips*2 (side hand grips and stretch grip)
 - Foot control for motorized vertical movement*2
 - Cassette holder*2
 - Grid*2

Detector

- Indirect conversion method + ISS*3 Flat Panel Detector
- Dimensions: 17" X 17" (43.2 X 43.2cm) single panel:
- Pixel size: 150µm
- Resolution: 2880 X 2880
- Density resolution: 16bit
- Panel cooling method: Fan cooled system

Console Advance

- High performance PC
- Monitor: 17" color TFT monitor (1280 X 1024 display matrix)
- Image preview: min. 2.5 sec (shortest)
- Completion of Image processing: min. 4.5 sec or less
- DICOM functions*2
- Image Intelligence™
- Automatic image stitching*2
- Energy subtraction*2
- Tomosynthesis*2

*1: The figures in [] apply when the output 80kW is selected

*2: Option

*3: Irradiation-side sampling

Dimensions

Unit mm (in.):

